

NO.	REVISIONS	DATE	INITIAL

PROJECT
REPLACEMENT SOUTH STAND
G.R.F.C. KINGSHOLM ROAD.

CLIENT
SLICK SEATING SYSTEMS LIMITED



FOR:
GLOUCESTER RUGBY FOOTBALL CLUB

DRAWING
GROUND FLOOR
FIFTH SECTOR DRAWING

SCALE
1:50

DATE
29.4.05 A.S

DRAWN
CHECKED



A.S.A ARCHITECTS

Architecture
Master Planning
Conservation

Island Culture
Tavara Street Torpoint, Cornwall, PL11 2AW
Mobile: 07770 421924, Fax: 01752 814004
e-mail: andystrange@btinternet.com.

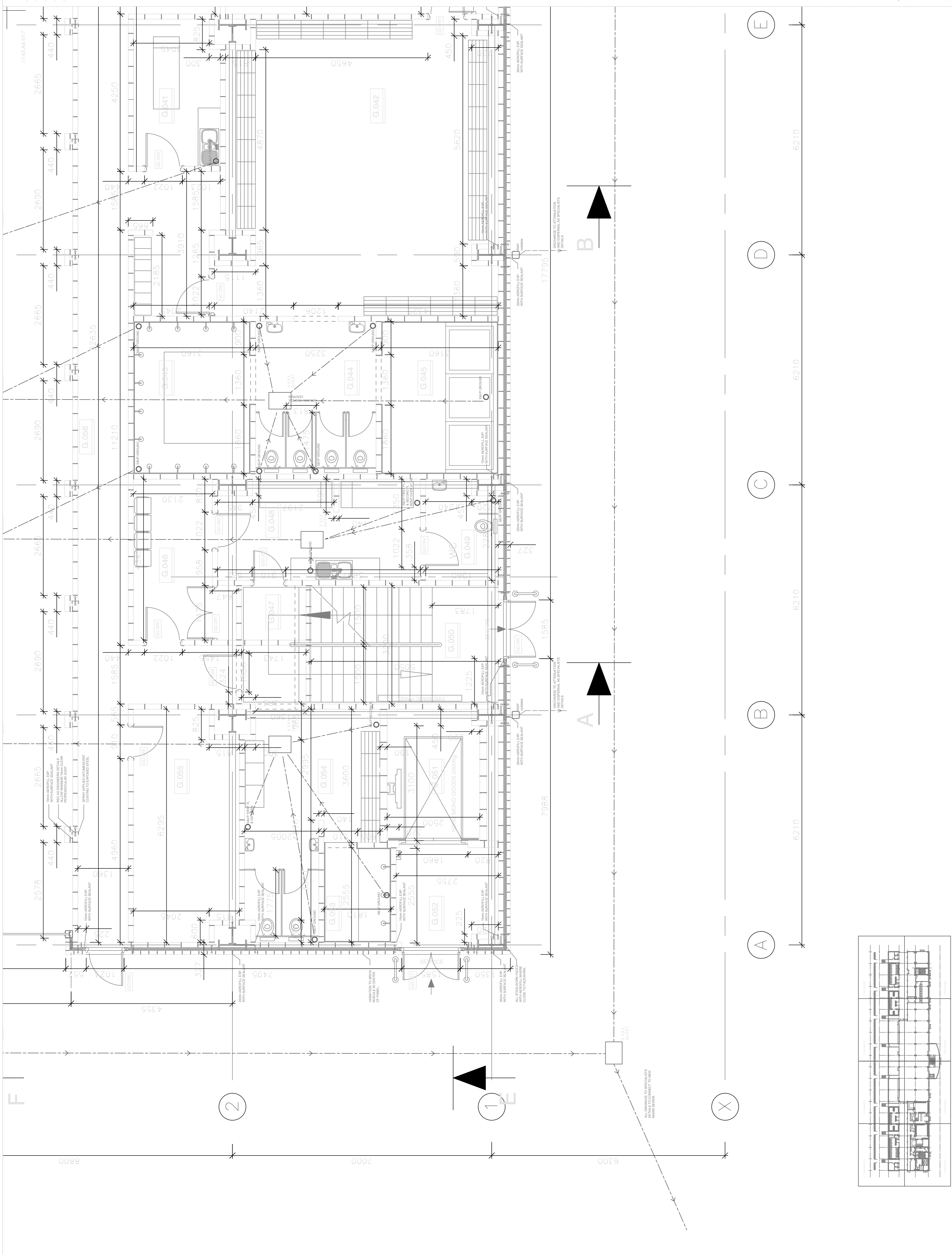

ALL STEELWORK TO BE GALVANNEAL
WALLS TO BE CONCRETE TO FACEWORK

20mm ANTI-FALL EXP. WITH SURFACE BRANANT

WALLS TO BE CONCRETE TO FACEWORK

WALLS TO BE CONCRETE TO FACEWORK

WALLS TO BE CONCRETE TO FACEWORK

(E)

(D)

(C)

(B)

(A)

(1)

(2)

(X)

